

Pozitie	Cantitate	Nume	Lungime	Greutate	Greuta
CVF1	4	RHS120x5			
CVF1	1	RHS120x5	2,013	35,8	
p24	4	PL 10x310x150	310	3,7	
p25	4	PL 5x112x48,5	112	0,2	
p31	2	PL 15x310x150	310	5,5	
p35	1	PL 15x275,08x249,86	275	6,8	
	48				

4x RHS120x5x2013 S235JRG2 - 1:10

CVF1

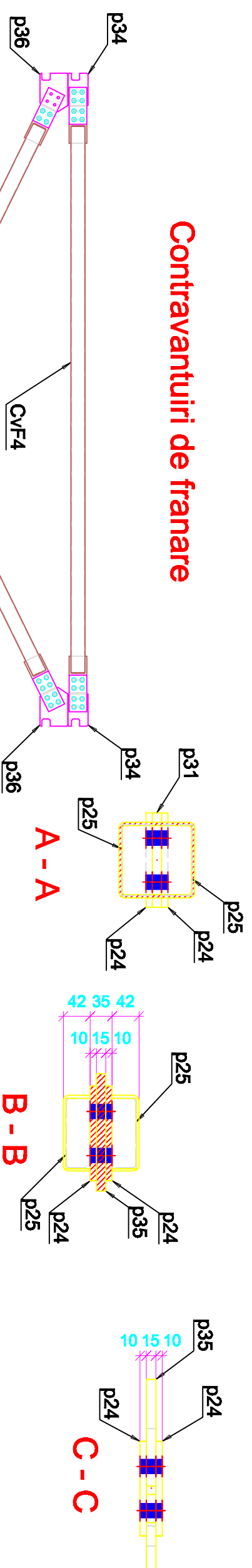
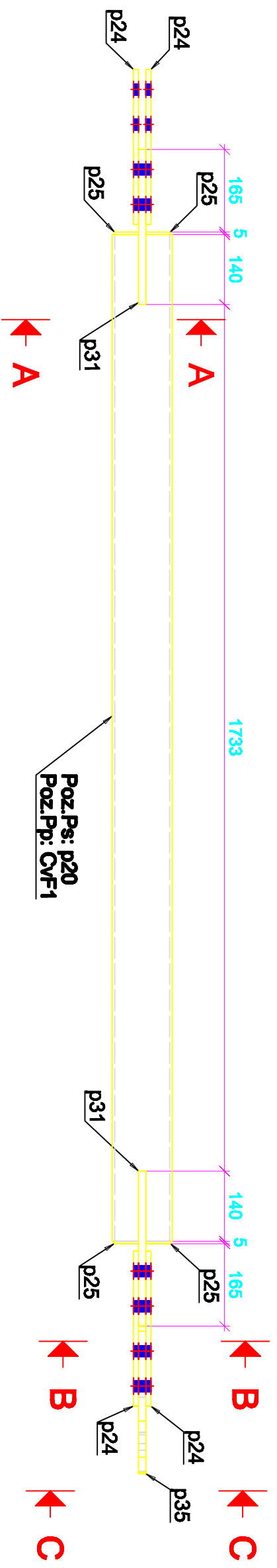
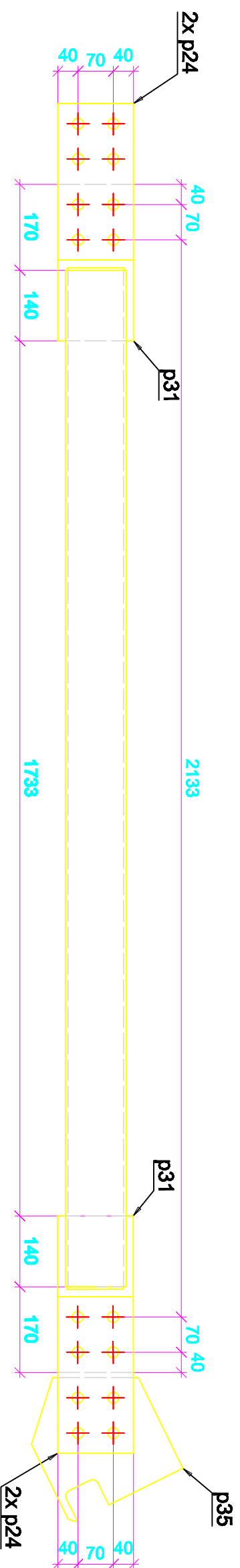

Contravanturi de franare

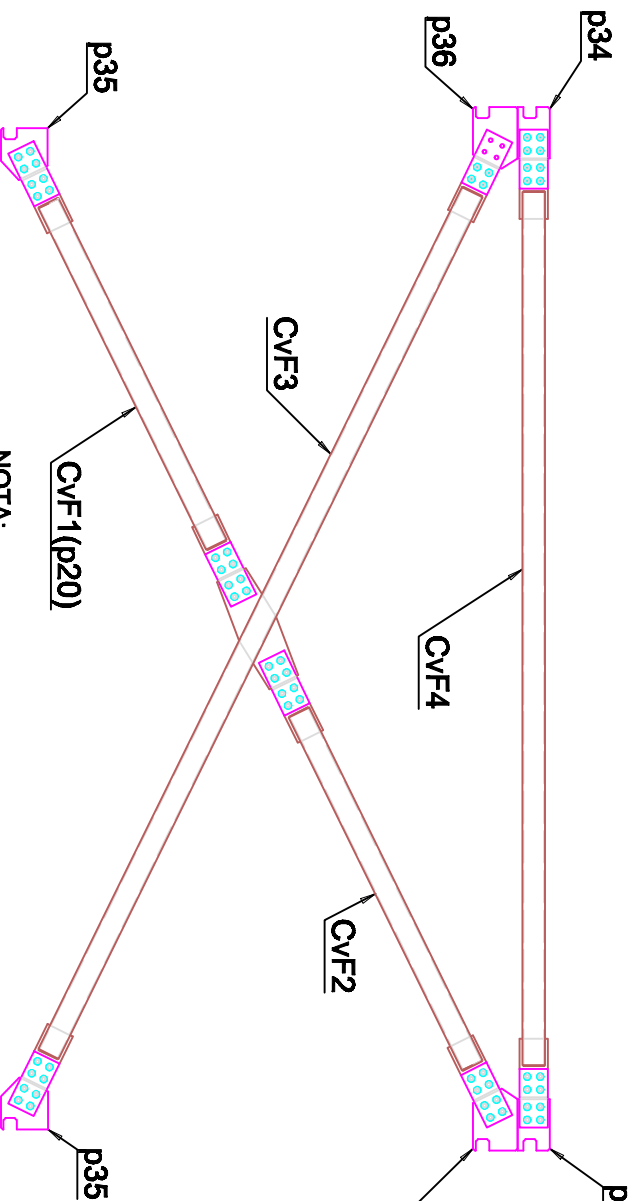

NOTA:
Pozitiile p34, p35, p36 se sudeaza de stalpi la montaj,
conform desen de ansamblu,
Daca se impune aceasta se vor ajusta la pozitie.

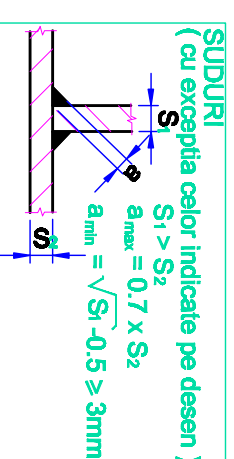

NOTA:
* Pentru reperele obtinute prin talere termica: EN ISO 9013-2:2002;
* Rugozitate pe taleturi: R_a ;
* Pentru prelucrari mecanice: abateri limita conform SR EN 22768-nK;
* Rugozitate ptr. suprafetele prelucrate mecanic: R_a ;
* Clasa de abateri limita la dimensiunile imbinarilor sudate este "BE" conform SREN ISO 13920/98;
* L sudura: pe tot conturul de contact; (Sudurile se vor poansonza)
* Se va marca numar ansamblu(CVF --).

DETALII DE ANSAMBLU

Antreprenor :
Desenat : **ing. C-tin Hriniciu**
Verificat : **ing. Dorel Mitrofan**
Data : 12/3/2014

Beneficiar : SC Concept SRL

Proiect : Cale de rulare Pod rulant 3,2 tone
Nr. proiect : **PP2014 11-001**
Material : **S235JRG2**

Scara : **1:0,1:40,1:7,5**
Pozitie : **CVF1**
Revizie : **0**
Nr. planşa : **R 005**

